

HATCHSAFE®



Installation Instructions/Operation and Maintenance Manual



Models:

Rev. B Models

Table of Contents:

Safety Precautions	2
Product Information	2
Operation	4
Installation Instructions	5
Replacement Parts List	8
Inspection and Maintenance.....	9
Warranty Certificate	11

Contact Information

Mail

PS Access Solutions
1150 South 48th Street
Grand Forks, ND 58201

Local Phone

701.746.4519

Website

psaccesssolutions.com

Hours of Operation

8 A.M. to 5 P.M. CT
Monday – Friday

Toll Free Phone

877.446.1519

Email

4psinfo@psindustries.com

IMPORTANT! Read entire Instruction and Operations Manual to become familiar with the product.

NOTICE This product is a commercial product. The effectiveness of the product is directly related to the proper installation and operation of this product. Failure to properly maintain this product **will** affect performance.

Publication Notice

This manual has been compiled and published covering the latest product descriptions and specifications.

The contents of this manual and the specifications of this product are subject to change without notice.

PS Access Solutions reserves the right to make changes without notice in the specifications and materials contained herein and shall not be responsible for any damages (including consequential) caused by reliance on the materials presented, including but not limited to typographical and other errors relating to the publication.

PS Access Solutions and/or its respective suppliers may make improvements and/or changes in the product(s)/ service(s) offered and/or the program(s) at any time without notice.

Retain this manual for future reference.

If you would like to download a copy of this manual, please go to psaccesssolutions.com

Product registration is an essential step to protecting your product, register Online at psindustries.com/contact/register-your-product/



Safety Precautions

The following icons are used throughout this Manual.

▲ DANGER Indicates an imminently hazardous situation which, if not avoided, will result in death or serious injury.

▲ WARNING Indicates a potentially hazardous situation which, if not avoided, could result in death or serious injury.

▲ CAUTION Indicates a potentially hazardous situation which, if not avoided, may result in minor or moderated injury.

NOTICE Indicates manufacturer's statement of additional information.

IMPORTANT! Indicates a required action.

CRITICAL Indicates a vital component to product performance.

HatchSafe® Product Information

NOTICE Unauthorized modification of or to the Product voids this Limited Warranty. Authorized modifications, received in writing from PS INDUSTRIES INCORPORATED, as long as the modification is accomplished in strict accordance with PS INDUSTRIES INCORPORATED's instructions, does not void warranty. To request product modifications contact PS INDUSTRIES INCORPORATED, 1150 S. 48th Street, Grand Forks, ND 58201, phone 877-446-1519, email: 4psinfo@psindustries.com

I. General Information

- A. This manual contains information regarding installation, operation, and maintenance of the PS Access Solutions' HatchSafe®.
- B. The HatchSafe® is designed to meet OSHA Railing Standard 1910.28(b) and 1910.29(b).
- C. PS Access Solutions recommends that the owner implement a regular maintenance program to inspect the HatchSafe® as necessary.

II. Operation Guidelines

- A. Operation in a manner other than intended could result in damage or less than acceptable performance at time of need, for which the manufacturer will not be held responsible

III. Safety Precautions

- A. Ensure opening is clear of all obstructions.
- B. Comply with all OSHA and ANSI Safety Regulations and/or company safety policies when installing.
- C. Install only on surfaces capable of supporting all loading.

▲ DANGER Ensure area below installation is blocked off from personnel during installation, and mounting surface is capable of supporting all loading. Structural analysis of mounting surface is the responsibility of the owner.

IV. Storage Prior to Installation of Product

- A. Store materials in a dry, ventilated location. If outdoor storage is required, block materials and tarp in a tent-like arrangement, elevated above the product with open sides to allow airflow.

V. Installation Site Preparation

NOTICE Before starting site preparation and installation of the HatchSafe®, read the entire Operation and Maintenance Manual and review all installation instructions thoroughly.

- A. Clear work area of any debris.
- B. Ensure you have the necessary tools available. * See page 3 for recommended tools.
- C. Obtained all required permits.
- D. Personnel: Determine the appropriate number of personnel required to perform installation and have them readily available at the project site. (1-2 people recommended)

HatchSafe® Product Information

NOTE: Inventory carton to ensure all parts are present for assembly/installation. Refer to part list below.

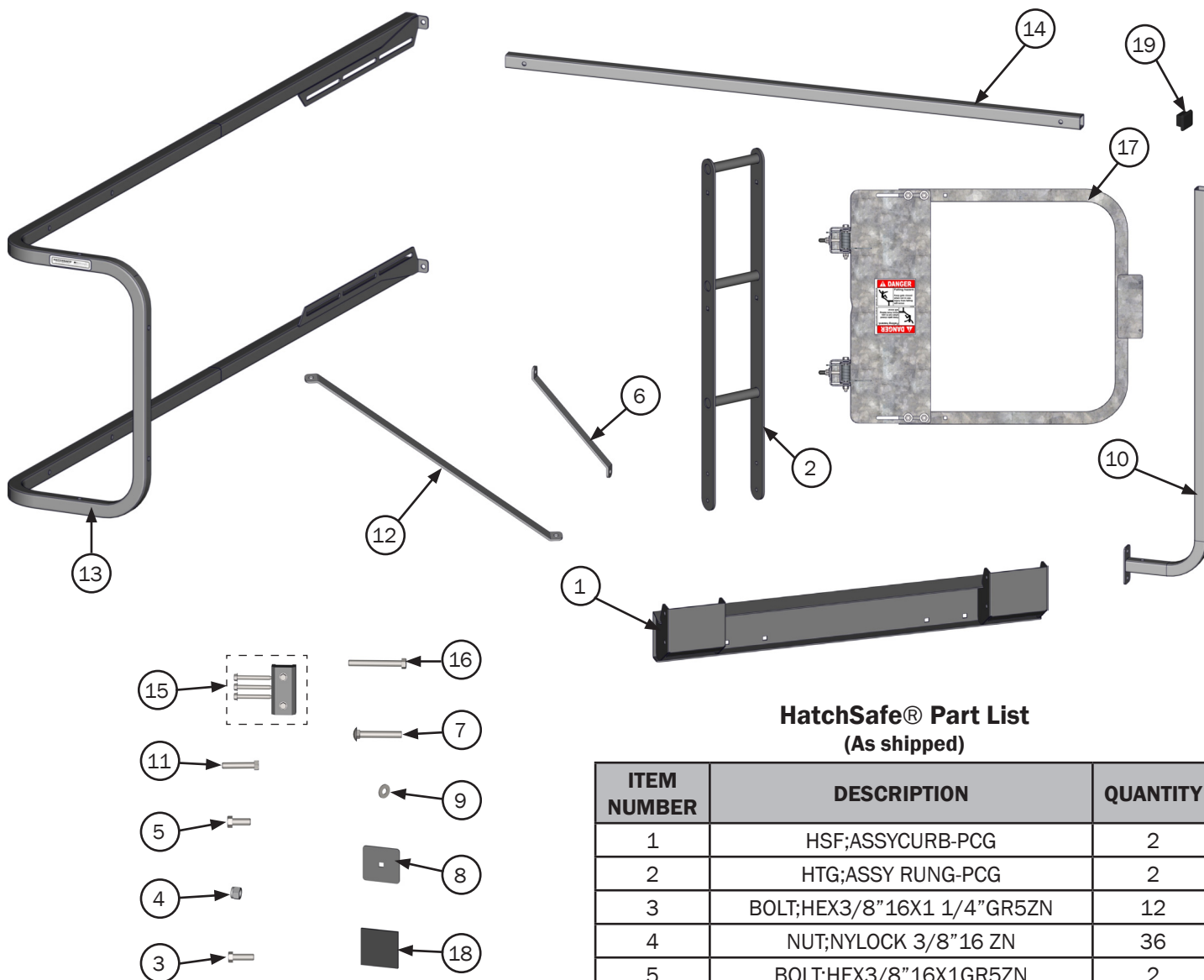

HatchSafe® Part List
(As shipped)

ITEM NUMBER	DESCRIPTION	QUANTITY
1	HSF;ASSYCURB-PCG	2
2	HTG;ASSY RUNG-PCG	2
3	BOLT;HEX3/8"16X1 1/4"GR5ZN	12
4	NUT;NYLOCK 3/8"16 ZN	36
5	BOLT;HEX3/8"16X1GR5ZN	2
6	HSF;UPPERSUPPORTSTRAP-PCG	2
7	BOLT;CARRIAGE3/8"16X2-1/2GR5ZN	8
8	HTG;CRUSH PLATE-PCG	8
9	WASHER;FLAT 3/8" ZN	12
10	HSF;VERTSUPPORTASSY-PCG	4
11	BOLT;HEX3/8"16X2GR5ZN	10
12	HSF;LOWERSUPPORTSTRAP-PCG	2
13	HSF;ASSY SIDE RAIL -PCG	1
14	HSF;BACKCROSSASSY-PCG	1
15	LSG;SUPPORT BLOCK KIT	1
16	BOLT;HEX3/8"16X3-1/4GR5ZN	4
17	LADDER SAFETY GATE (LSG)	*1
18	WS;CURB/CRUSH PLT WEATHER SEAL	8
19	CAP;SQ,BLK PLAST, 1-1/4" O.D.	14

Recommended Tools:

1. Two (2) 9/16" Wrenches
2. One (1) 1/2" Wrench
3. One (1) Electric Drill
4. One (1) 7/16" Drill Bit
5. One (1) Tape Measure
6. One (1) Level
7. One (1) Nut Driver

HatchSafe® Operation

NOTICE Operation in a manner other than intended could result in damage or less than acceptable performance, for which the manufacturer will not be held responsible.

VI. Operation

A. HatchSafe® (See Illustration A)

1. The HatchSafe® is a full railing system with a self-closing gate and integrated grab bars. This product is designed specifically for Roof Hatch openings.

B. HatchGrip® Grab Bars (See Illustration B)

1. The HatchSafe® railing system has integrated horizontal grab bars which are intended to assist in ascending and descending the ladder.

C. Ladder Safety Gate (See Illustration C)

1. Self-closing Ladder Safety Gate is attached to the full hatch railing system to protect roof opening and allow safe access to the hatch.
2. DO NOT USE THE LADDER SAFETY GATE AS A GRAB SURFACE.

**Operation
Illustration A**

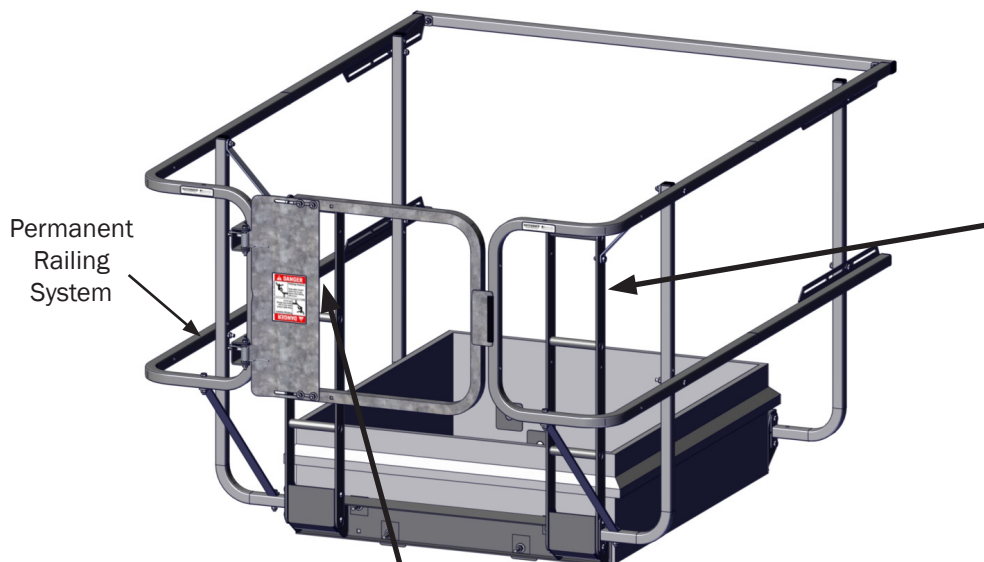

**Operation
Illustration B**

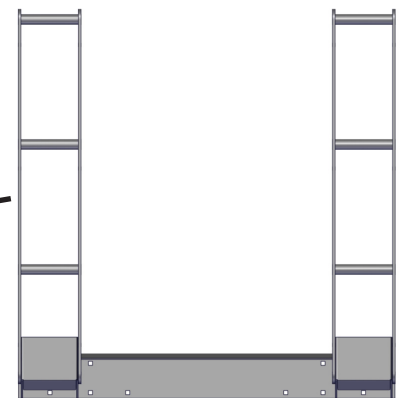

HatchGrip® Grab Bars ensure a firm, stable grip while ascending and descending the roof hatch.

**Operation
Illustration C**



OSHA Compliant
Ladder Safety Gate

HatchSafe® Installation

VII. HatchSafe® Installation

STEP 1. Install the Curb Bracket to the Hatch Curb Front, (the side with the ladder)

- Determine the mounting height of the Curb Bracket
- Square crush plate must be mounted to the interior of the hatch so you will have to allow for clearance.

IMPORTANT! Bottom rung must be higher than the top of the Hatch. (See Illustration A)

- Once height and center have been determined, mark the four holes that will be used while fastening to the existing curb. (See Illustration A)

IMPORTANT! It is recommended to select the mounting holes closest to the corners of the hatch assembly (Recommended holes are shown, the recommended holes shown are not the ones closest to the corners of the hatch.)

IMPORTANT! Step 1:c MUST be done before fastening curb assembly to existing curb.

- When holes are marked and you have ensured crush plate will fit, match drill holes with the $\frac{7}{16}$ " Drill Bit to ensure proper alignment.
- Attach the crush plate weatherseal at the anchor locations between curb assembly and existing hatch curb. (See Illustration B)
- Fasten curb assembly to front of existing hatch curb using $\frac{3}{8}$ " x $2\frac{1}{2}$ " carriage bolt, $\frac{3}{8}$ " washer, and $\frac{3}{8}$ " nylock nut.
- Install curb assembly to the rear of the hatch curb at same height. (Repeat Step 1:b through Step 1:f)

**Step 1
Illustration A**

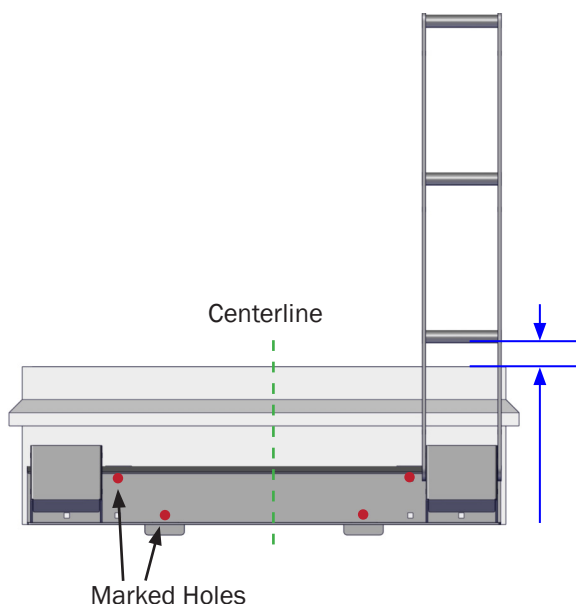

**Step 1
Illustration B**

IMPORTANT! Place the crush plate weatherseals on the back side of the curb bracket with corresponding holes to be used.

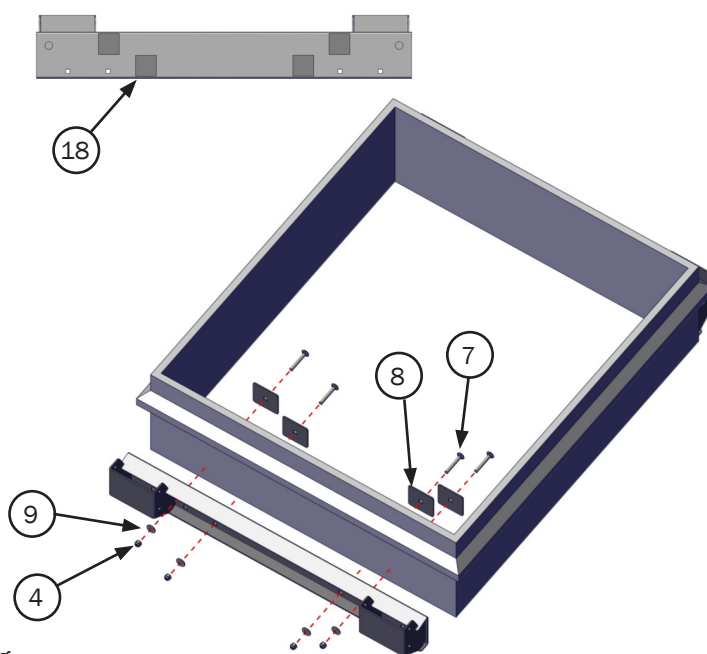

IMPORTANT! Make sure rung is above hatch cap flashing.

HatchSafe® Installation

STEP 2. Attaching HatchGrip® and Vertical Posts

- After the front curb assembly has been mounted, attach the two HatchGrip®, and all four vertical posts with the provided $\frac{3}{8}$ " x $1\frac{1}{4}$ " hex bolts and $\frac{3}{8}$ " flange nuts.

**Step 2
Illustration A**

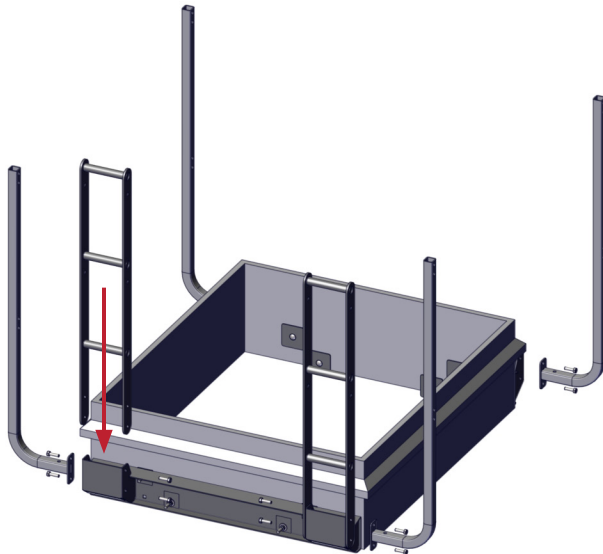

**Step 2
Illustration B**

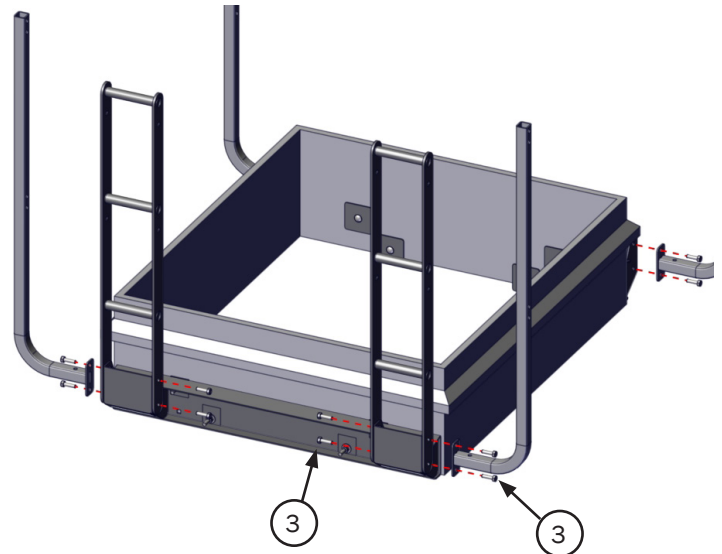

STEP 3. Attaching the Side Rails and Upper Support Straps to the Vertical Posts

- Make sure the railing opening will be in front of the HatchGrip® ladder rungs.
- Bolt the front (opening side) of the railing system and upper support straps to the vertical posts on both sides with provided $\frac{3}{8}$ " x $3\frac{1}{4}$ " hex bolts and $\frac{3}{8}$ " nylock nuts.
- Attach the upper support strap to the HatchGrip® assembly using a $\frac{3}{8}$ " x 1" hex bolt and $\frac{3}{8}$ " nylock nut.
- Repeat Step 3:a and Step 3:b for the opposite rail.

**Step 3
Illustration A**

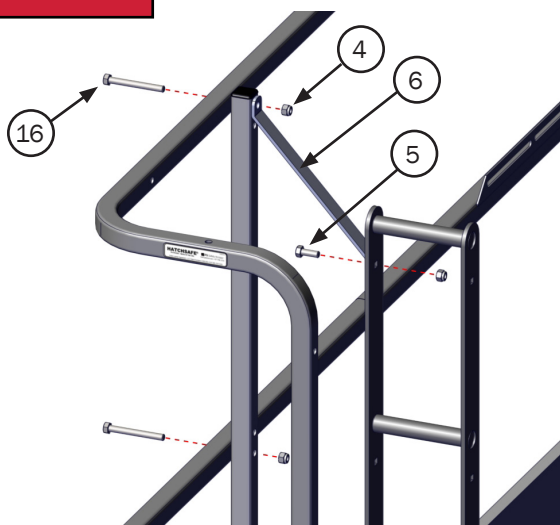

**Step 3
Illustration B**

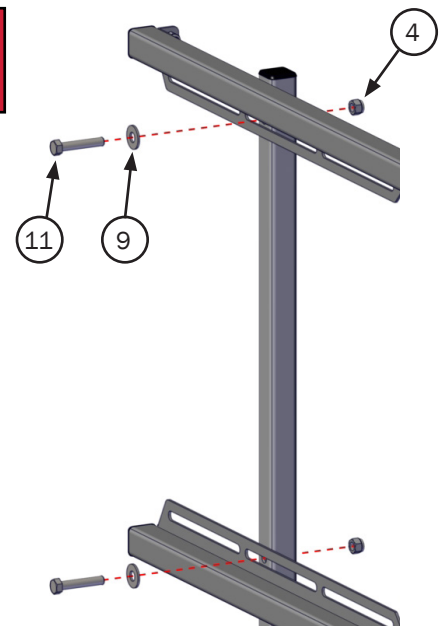

HatchSafe® Installation

STEP 4. Attaching the Back Rail

- Attach the back rail to the upper railing tabs using the $\frac{3}{8}$ " x 2" hex bolts and $\frac{3}{8}$ " nylock nuts. (See Illustration A)
- At this point, your HatchSafe® should look like Illustration B.

**Step 4
Illustration A**

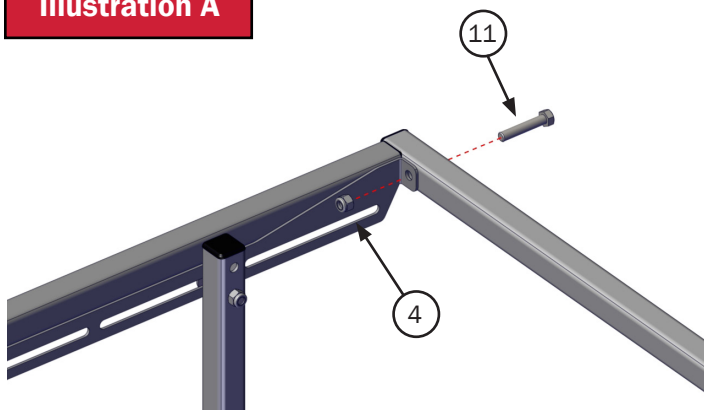

**Step 4
Illustration B**

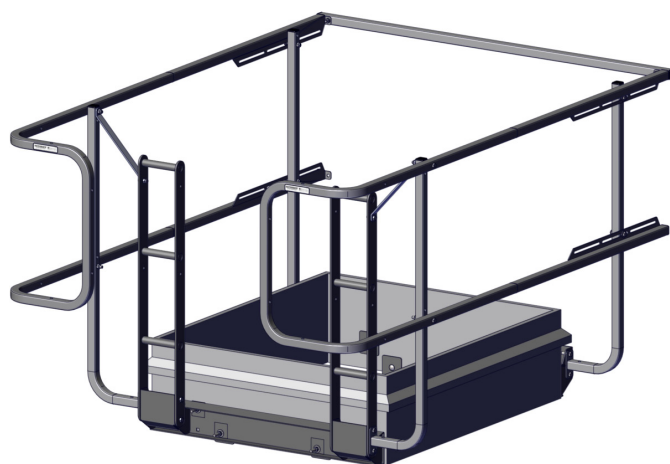

STEP 5. Adding the Lower Support Straps

- Bolt the lower support straps to the bottom of the vertical posts with provided $\frac{3}{8}$ " x 2" hex bolts, $\frac{3}{8}$ " nylock nuts, and the lower bar of the opening rails. (See Illustration)

STEP 6. Installing the Ladder Safety Gate (LSG)

- When all HatchSafe® components are installed and fastened, install the provided Ladder Safety Gate and Support Block Kit.
*See included Ladder Safety Gate O&M Manual for installation instructions.
- See Illustration for finished HatchSafe® product.

**Step 5
Illustration**

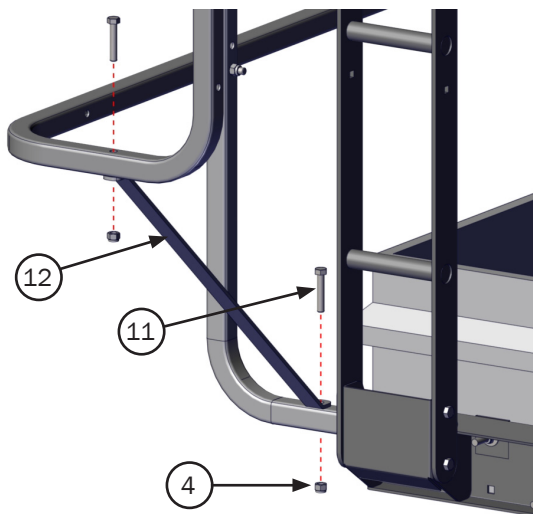

**Step 6
Illustration**

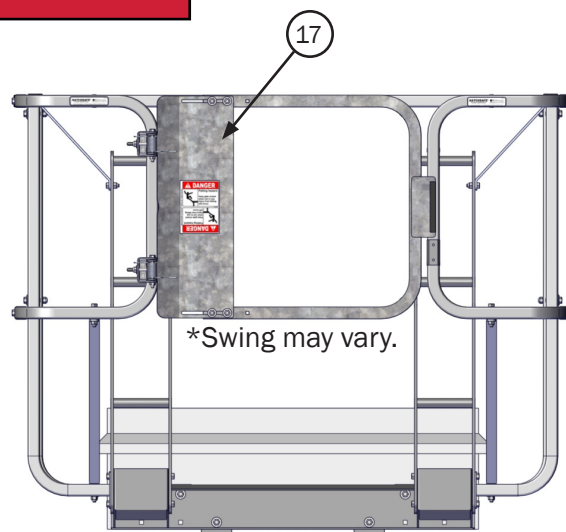

Replacement Parts List

VIII. Replacement Parts List

NOTE 1. This diagram is for all HatchSafe® Rev B Models. *Details A-C are located on Page 9.

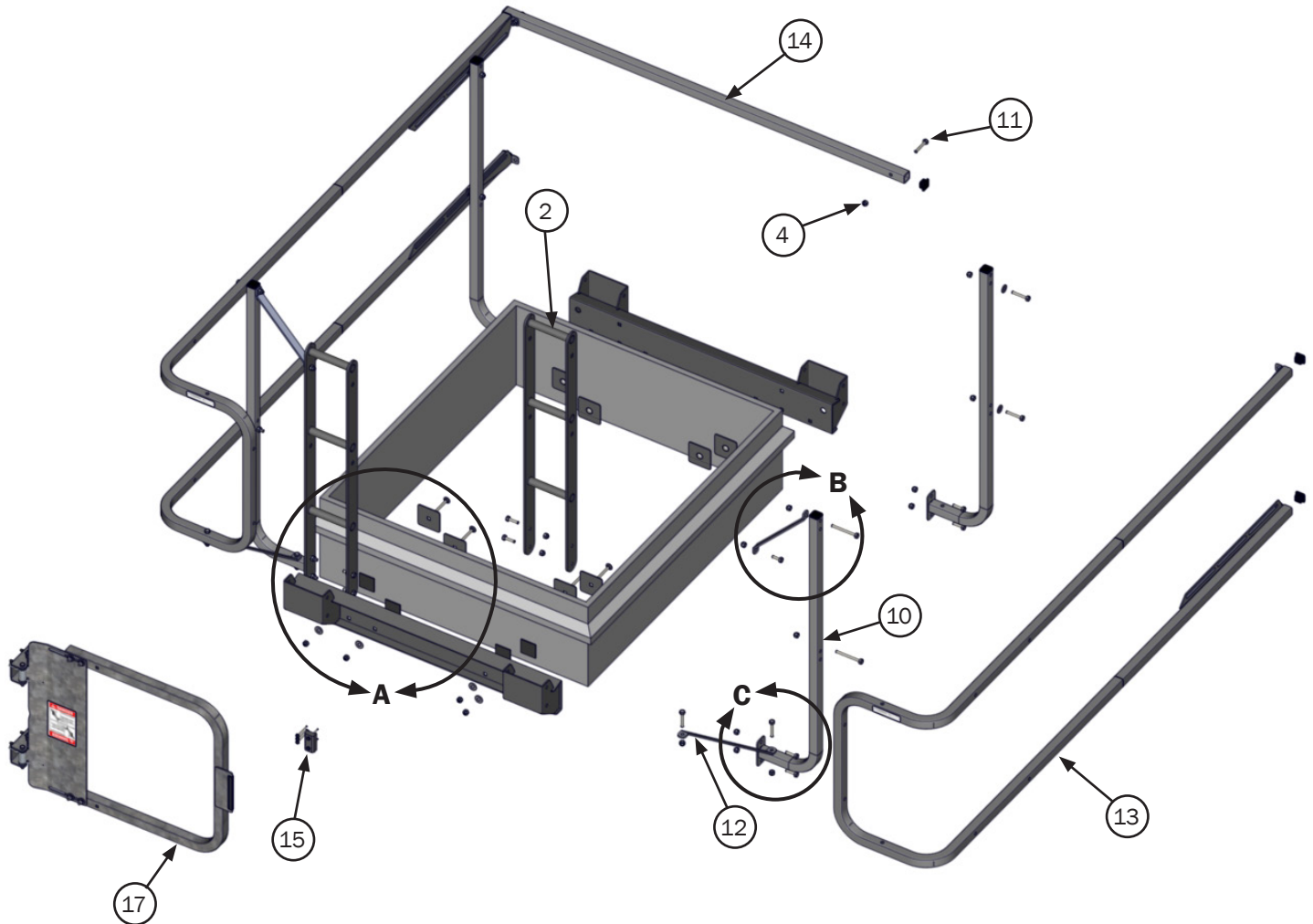

*Details located on Page 9.

GATE FINISH TYPE			
ITEM #	DESCRIPTION	QTY	PART #
1	HSF;ASSYCURB-PCG	2	511921
2	HTG;ASSY RUNG-PCG	2	500802
3	BOLT;HEX3/8"16X1 1/4"GR5ZN	12	500401
4	NUT;NYLOCK 3/8"16 ZN	36	501120
5	BOLT;HEX3/8"16X1GR5ZN	2	500400
6	HSF;UPPERSUPPORTSTRAP-PCG	2	511925
7	BOLT;CARRIAGE3/8"16X2-1/2	8	500320
8	HTG;CRUSH PLATE-PCG	8	500807
9	WASHER;FLAT 3/8" ZN	12	501947
10	HSF;VERTSUPPORTASSY-PCG	4	**
11	BOLT;HEX3/8"16X2GR5ZN	10	500407

GATE FINISH TYPE			
ITEM #	DESCRIPTION	QTY	PART #
12	HSF;LOWERSUPPORTSTRAP-48"PCG	2	511924
13	HSG;ASSY SIDE RAIL -PCG	2	**
14	HSF;BACKCROSSASSY-PCY	1	**
15	LSG;SUPPORT BLOCK KIT	1	503633
16	BOLT;HEX3/8"16X3-1/4GR5ZN	4	502933
17	LADDER SAFETY GATE (LSG)	1	**
18	WS;CURB/CRUSH PLT WEATHER SEAL	8	511040
19	CAP;SQ,BLK PLAST, 1-1/4" O.D.	14	508144

**Part # dependent on size/finish of gate. Consult factory.

**TO ORDER PARTS CONTACT PS ACCESS SOLUTIONS AT
877.446.1519 or 4psinfo@psindustries.com**

Replacement Parts List

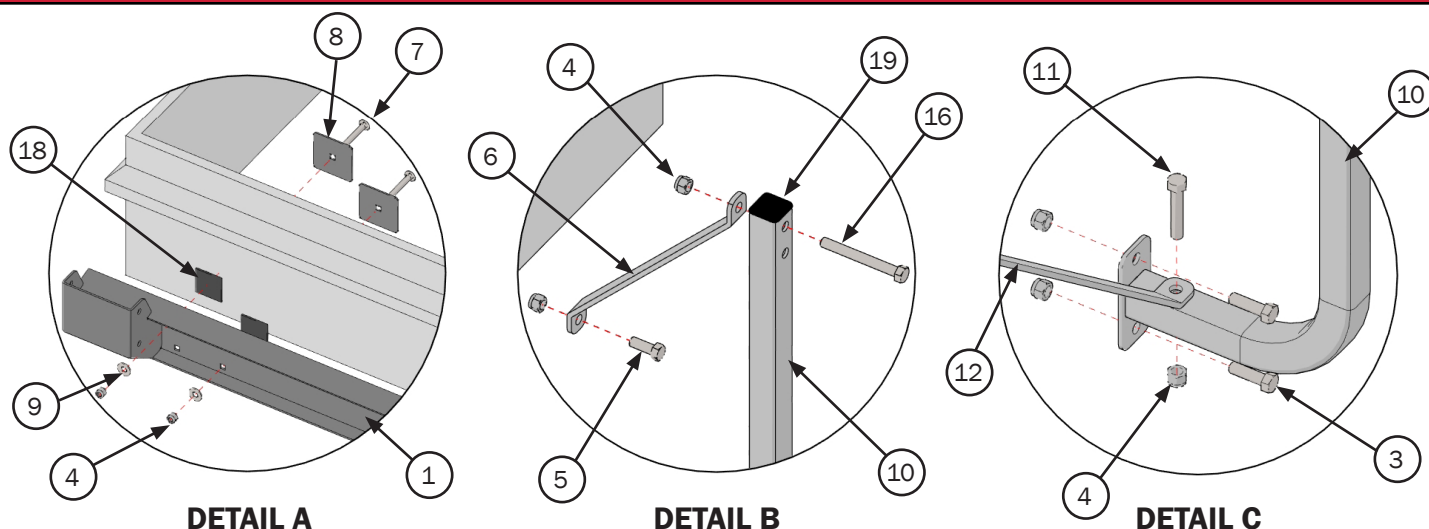

Inspection and Maintenance

IX. Inspection and Maintenance (Minimum Annually)

IMPORTANT! Consult parts list before replacing fasteners, as all have specific design load requirements. Only use like items for replacement.

A. Frame Assembly:

1. Inspect components for damage and misalignment. Adjust, repair, or replace as needed, to meet original design tolerance.
2. Check black square plastic caps for cracks, replace as necessary.

B. Gate Assembly:

1. Inspect gates for corrosion or damage, repair or replace as necessary.
2. Check gates for proper alignment with catch. Adjust as necessary to achieve proper alignment.

C. Fasteners and mechanical connections:

1. All fasteners must be in place and adjusted to their original design standard.
2. Replace any damaged components.
3. Check all mounting connections, making sure they meet original design standards (refer to Installation instructions).

D. Finishes:

1. Inspect all surfaces for signs of wear or corrosion and clean finishes periodically.
2. Touch up repair finishes, or refinish as necessary to protect the structural integrity.
3. The HatchSafe® comes with a polyester powder coat finish. Use finish materials compatible with powder coat. Follow paint manufacturers' instructions for prep and touch-up.

E. Housekeeping:

1. To ensure your product continues to operate and last, upon completion of proper installation, complete the following:
 - a. Clean all surfaces.
 - b. If project is ongoing, protect installed products until final completion of project.
 - c. Touch-up, repair, or replace damaged components.
2. Clean track of any debris and keep the area clean through the operating area of the hatch, including snow removal. Build up of ice or snow on the track will hinder the smooth operation of the hatch.

F. Labels and Placards:

1. Inspect all labels and placards.
2. Replace any labels and placards which are unreadable/missing.

Inspection and Maintenance Log

CRITICAL Periodic Inspection and Maintenance Required. Inspect at minimum annually.

Date Purchased: _____

Product: _____

Model Number: _____

Serial Number: _____

Opening Identifier/ Number: _____

Location: _____

DATE INSPECTED	INSPECTED BY <i>(Print & Sign)</i>	INSPECTION ITEMS NOTED	CORRECTIVE ACTION	CORRECTED BY <i>(Print & Sign)</i>

PS INDUSTRIES INCORPORATED – LIMITED WARRANTY

Limited Warranty: Subject to the terms of this Limited Warranty, PS INDUSTRIES INCORPORATED warrants to the original user or consumer (the "Owner") of a PS INDUSTRIES INCORPORATED product (the "Product") that, for a period of one (1) year from date of shipment, the Product will be free from defects in material and workmanship under normal use and service, and provided the Product is installed, operated and maintained in accordance with instructions supplied by PS INDUSTRIES INCORPORATED. The terms and limitations of this Limited Warranty apply to all repaired or replacement Products for a term equal to the balance of the warranty remaining on the Product that was repaired or replaced as of the date of such repair or replacement. Register online at: www.psindustries.com/contact/register-your-product

PS Flood Barriers™ Product Warranty Registration: For PS Flood Barriers™ Products, this Limited Warranty will only be valid if the Owner completes the Warranty Registration Form provided within thirty (30) days of Product installation. To request a copy of the Warranty Registration Form, contact PS INDUSTRIES INCORPORATED, 1150 S. 48th Street, Grand Forks, ND 58201, phone 877-446-1519, email: 4psinfo@psindustries.com. Register online at: www.psindustries.com/contact/register-your-product/ Additional Warranty Registration Forms can be downloaded at www.psfloodbarriers.com/download-center/

Warranty Exclusions: Notwithstanding anything to the contrary, this Limited Warranty does not cover any of the following:

1. Normal wear and tear (including, but not limited to, normal wear and tear to gaskets and weather seals); damage or accidents resulting from freight damage, from failure to follow precautionary safety measures, or applied paint failure; abuse, misuse or unauthorized modification of the Product; misapplication; improper installation; or any defects, damage or other harm that is not the result of the acts or omissions of PS INDUSTRIES INCORPORATED.
2. Cost of field labor or other charges incurred by Owner in removing and/or re-affixing the Product or any part or component thereof.
3. Transportation costs.

Unauthorized modification of or to the Product voids this Limited Warranty. Authorized modifications, received in writing from PS INDUSTRIES INCORPORATED, as long as the modification is accomplished in strict accordance with PS INDUSTRIES INCORPORATED's instructions, does not void warranty. To request product modifications contact PS INDUSTRIES INCORPORATED, 1150 S. 48th Street, Grand Forks, ND 58201, phone 877-446-1519, email: 4psinfo@psindustries.com.

Claim Procedure: To make a claim under this Limited Warranty, the claim must be received by PS INDUSTRIES INCORPORATED before the expiration of the above stated Limited Warranty period together with proof of purchase. Contact PS INDUSTRIES INCORPORATED at the address shown below.

PS INDUSTRIES INCORPORATED	Toll Free: 877-446-1519
Attention: Warranty	Phone: 701-746-4519
1150 S. 48th Street	Fax: 701-746-8340
Grand Forks, ND 58201	E-mail: 4psinfo@psindustries.com

An authorized PS INDUSTRIES INCORPORATED representative must be given a reasonable opportunity to inspect and investigate the alleged Product defect prior to any work being done that affects the Product or its installation. PS INDUSTRIES INCORPORATED reserves the right to charge reasonable amounts for travel and labor associated with investigation of claims. PS INDUSTRIES INCORPORATED may also require photographs of the alleged Product defect or return of the Product or part to a designated PS INDUSTRIES INCORPORATED location, freight prepaid. A return goods authorization must be received prior to the return of the Product or part. Please contact PS INDUSTRIES INCORPORATED to determine the designated location for return and to obtain the return material authorization.

Exclusive Remedy: In the event of a warranty claim that PS INDUSTRIES INCORPORATED determines to be covered by this Limited Warranty, PS INDUSTRIES INCORPORATED will replace or repair, at PS INDUSTRIES INCORPORATED's discretion, the Product or any part of the Product found to be defective.

Disclaimers: The above warranty and remedy is the sole express warranty and remedy given by PS INDUSTRIES INCORPORATED on its Product. No warranties or representations at any time made by any representative from PS INDUSTRIES INCORPORATED shall vary or expand the provisions hereof. TO THE EXTENT PERMITTED BY LAW, ALL EXPRESS AND IMPLIED WARRANTIES (INCLUDING IMPLIED WARRANTIES OF MERCHANTABILITY, FITNESS FOR A PARTICULAR PURPOSE AND NON-INFRINGEMENT) OTHER THAN THE EXPRESS LIMITED WARRANTY SET FORTH ABOVE ARE EXPRESSLY DISCLAIMED. UPON THE EXPIRATION OF THE ABOVE STATED LIMITED WARRANTY PERIOD, ANY AND ALL APPLICABLE IMPLIED WARRANTIES, INCLUDING, WITHOUT LIMITATION, WARRANTIES OF MERCHANTABILITY, FITNESS FOR A PARTICULAR PURPOSE AND NON-INFRINGEMENT, ARE DISCLAIMED. SOME STATES DO NOT ALLOW LIMITATION ON HOW LONG AN IMPLIED WARRANTY LASTS, SO THE ABOVE LIMITATION MAY NOT APPLY TO OWNER.

LIABILITY LIMITATION: In no event will PS INDUSTRIES INCORPORATED's liability to Owner or any other person or entity exceed the price paid to PS INDUSTRIES INCORPORATED for the defective Product. IN NO EVENT SHALL PS INDUSTRIES INCORPORATED BE LIABLE TO OWNER OR ANY OTHER PERSON OR ENTITY FOR INCIDENTAL, CONSEQUENTIAL, INDIRECT OR SPECIAL DAMAGES OF ANY DESCRIPTION, WHETHER ARISING OUT OF WARRANTY (INCLUDING ANY IMPLIED WARRANTIES) OR ANY OTHER CONTRACT, STRICT LIABILITY, NEGLIGENCE OR OTHER TORT, OR OTHERWISE, INCLUDING ARISING FROM INSPECTION OR REMEDY DELAYS. SOME STATES DO NOT ALLOW THE EXCLUSION OR LIMITATION OF INCIDENTAL OR CONSEQUENTIAL DAMAGES, SO THE ABOVE LIMITATION AND EXCLUSION MAY NOT APPLY TO OWNER.

THIS WARRANTY GIVES OWNER SPECIFIC LEGAL RIGHTS AND OWNER MAY ALSO HAVE OTHER RIGHTS, WHICH VARY FROM STATE TO STATE.

Rev. 010719



877.446.1519

4psinfo@psindustries.com | psaccesssolutions.com

1150 South 48th Street | Grand Forks, ND 58201

Product Registration:

psindustries.com/contact/register-your-product