

Horizontal Mezzanine Gate

Installation Manual

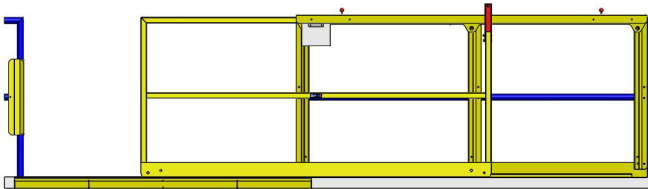

PS Safety Access™
We Won't Let You Down



Models
MGHM
MGHE

Table of Contents

Product Information	2
Parts As Shipped	3
Installation Instructions	4
Warranty Information	14

PS DOORS Contact Information

Mail PS DOORS PS Safety Access 1150 South 48th Street Grand Forks, ND 58201	Local Phone 701.746.4519 Toll Free Phone 877.446.1519	Fax 701.746.8340 Website www.psdoors.com	Email 4psinfo@psdoors.com Hours of Operation 8 A.M. to 5 P.M. CT Monday – Friday
--	--	--	--

IMPORTANT! Read entire Instruction and Operations Manual to become familiar with the product.

NOTICE This product is a horizontal mezzanine gate. The effectiveness of the product is directly related to the proper installation and operation of this product. Failure to properly maintain this product **will** affect performance.

Publication Notice

This manual has been compiled and published covering the latest product descriptions and specifications.

The contents of this manual and the specifications of this product are subject to change without notice.

PS DOORS reserves the right to make changes without notice in the specifications and materials contained herein and shall not be responsible for any damages (including consequential) caused by reliance on the materials presented, including but not limited to typographical and other errors relating to the publication.

PS DOORS and/or its respective suppliers may make improvements and/or changes in the product(s)/service(s) offered at any time without notice.

Retain this manual for future reference.
If you would like to download an 8.5"x11" copy of this manual, please go to psdoors.com

Safety Precautions

The following icons are used throughout this Manual.

▲ DANGER Indicates an imminently hazardous situation which, if not avoided, will result in death or serious injury.

▲ WARNING Indicates a potentially hazardous situation which, if not avoided, could result in death or serious injury.

▲ CAUTION Indicates a potentially hazardous situation which, if not avoided, may result in minor or moderated injury.

NOTICE Indicates manufacturer's statement of additional information.

IMPORTANT! Indicates a required action.

CRITICAL Indicates a vital component to product performance.

Horizontal Mezzanine Gate Product Information

I. General Information

- A. This manual contains information regarding installation, operation, and maintenance of the Horizontal Mezzanine Gate.
- B. The Horizontal Mezzanine Gate is designed to meet Federal OSHA standards 1910.28 and 1910.29.
- C. PS DOORS recommends that the owner implement a regular maintenance program to inspect the Horizontal Mezzanine Gate as necessary.

NOTICE This product is manufactured to specific guidelines. Unauthorized alteration in any way will result in voiding Factory Warranty, and may cause product to fail with potential serious consequences. Accordingly, if the product requires service after unauthorized modification, you can expect any request for warranty repair to be charged to you. Authorized modifications, received in writing from PS DOORS, as long as the modification is accomplished strictly in accordance with PS DOORS' instructions, does not void warranty. To request product modifications contact PS DOORS.

II. Storage Prior To Installation of Product

- A. Store materials in a dry, ventilated location. If outdoor storage is required, block materials and tarp in a tent-like arrangement, elevated above the product with open sides to allow airflow.

NOTICE Before beginning any portion of the site preparation and installation of the Horizontal Mezzanine Gate, read the entire Operation and Maintenance Manual.

III. Installation Site Preparation

- A. Clear work area of any debris.
- B. Ensure you have the necessary tools available. (Minimum recommended tools):
 1. One (1) Philips Screw Driver
 2. One (1) Pliers
 3. One (1) 7/16" Wrench
 4. One (1) 1/2" Wrench
 5. One (1) 9/16 Wrench
 6. One (1) Tape Measure
 7. One (1) Level
 8. Depending on anchoring configuration, additional tools may be required

▲ DANGER Ensure area below installation is blocked off from personnel during installation, and mounting surface is capable of supporting all loading. Structural analysis of mounting surface is the responsibility of the owner.

IV. Safety Precautions

- A. Comply with all OSHA Safety Regulations and/or company safety policies when installing.
- B. Personnel: Determine the appropriate number of personnel required to perform installation and have them readily available at the project site. (2-3 people recommended)

Installing Horizontal Mezzanine Gate

Inventory carton to ensure all parts are present for assembly/installation. Refer to part list below.

Horizontal Mezzanine Gate Part List (As shipped)

ITEM #	DESCRIPTION	QTY	USES
1	GATE STRUCTURE	1	ALL
2	SHROUD STRUCTURE	1	ALL
3	GATE HOUSING TRACK	1	ALL
4	FACE MOUNT TRACK	1	FACE MOUNT
5	GATE HARDWARE KIT	1	ALL
6	TRACK SHROUD HARDWARE KIT	1	ALL
7	MANUAL HARDWARE KIT	1	MANUAL
8	ELECTRIC OPERATOR KIT	1	ELECTRIC

Parts are not to scale.

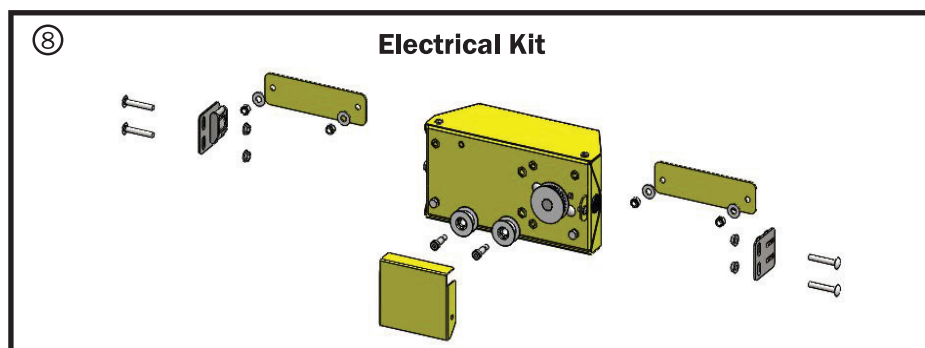
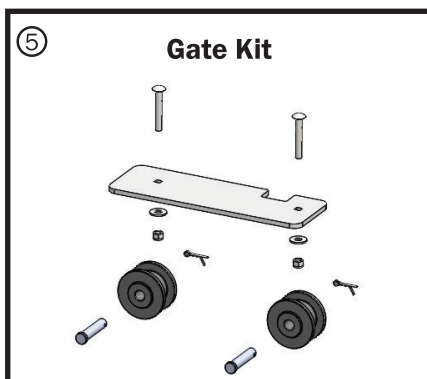
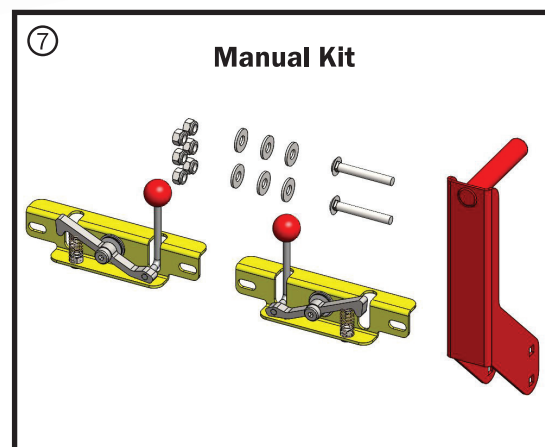
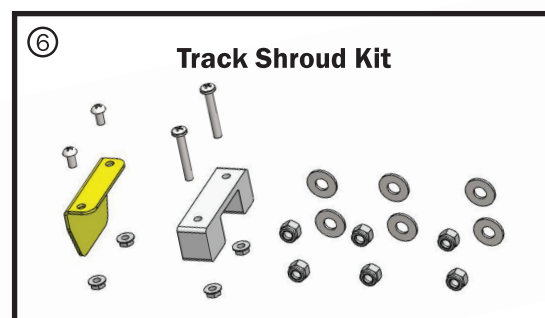
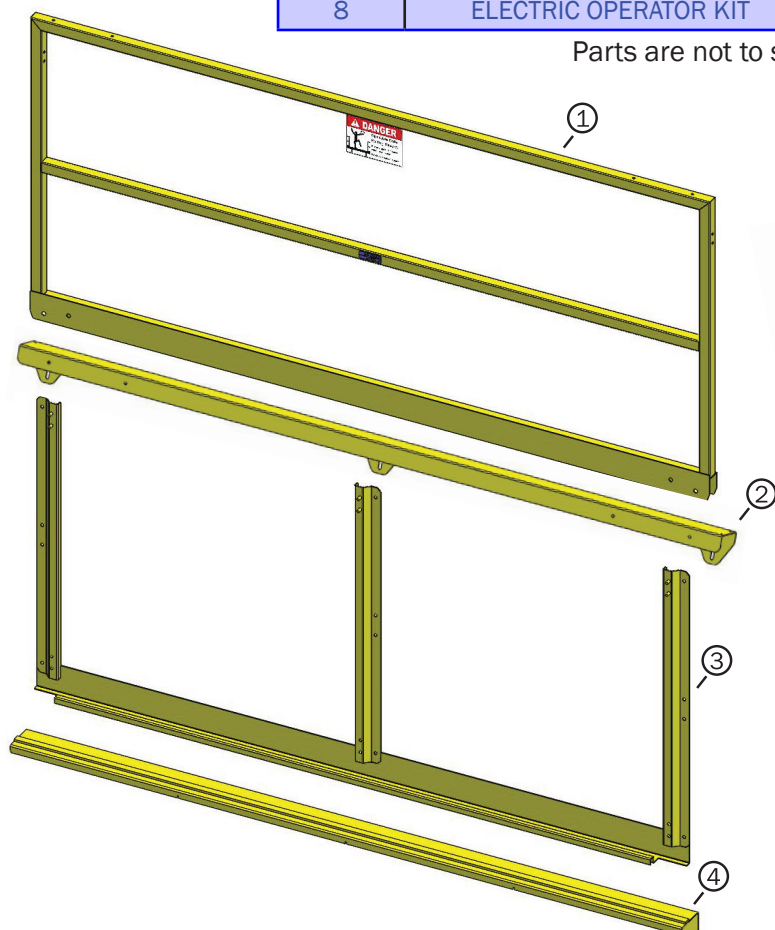

Determine Gate Attributes

Please Check the attributes you wish to use. This will help for future reference.

Will your gate Slide open to the Right or Left as viewed from ground level? (See below)

☐ Slide Right to Open (+) ☐ Slide Left to Open (-)

Will your gate be Deck Mount, or Face Mount?

☐ Deck Mount (After Step 1. go to Step 2.) ☐ Face Mount (After Step 1. go to Step 3.)

Will your gate be Manual or Electric?

☐ Manual ☐ Electric

Slide Direction

Step 1 (See Illustrations 1. & 2.)

A. To determine what slide direction is needed, look up at the mezzanine from the ground level.

CRITICAL Your gate should open to the direction that allows the most room for operation.

Illustration 1. Slide Right view from ground.

If you have chosen Slide Right, you will install your gate using the holes marked with a (+) sign.

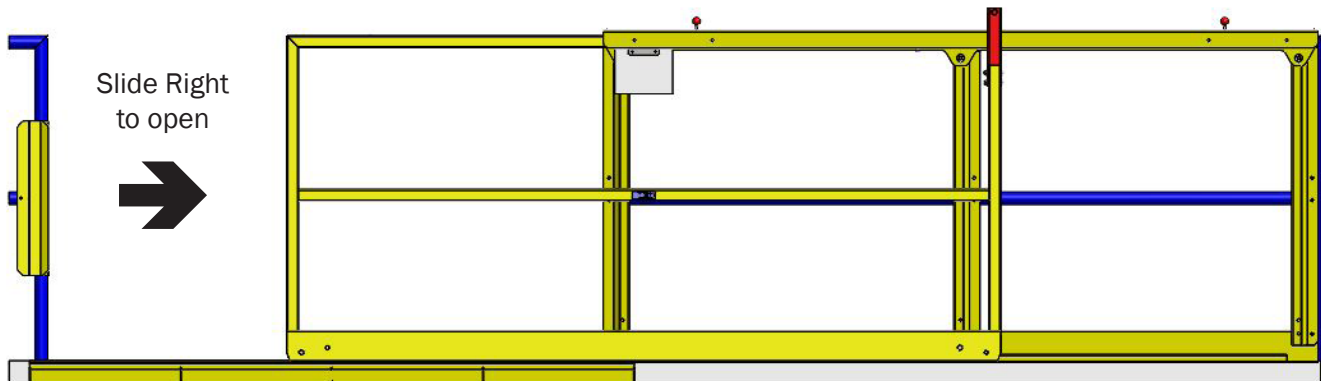
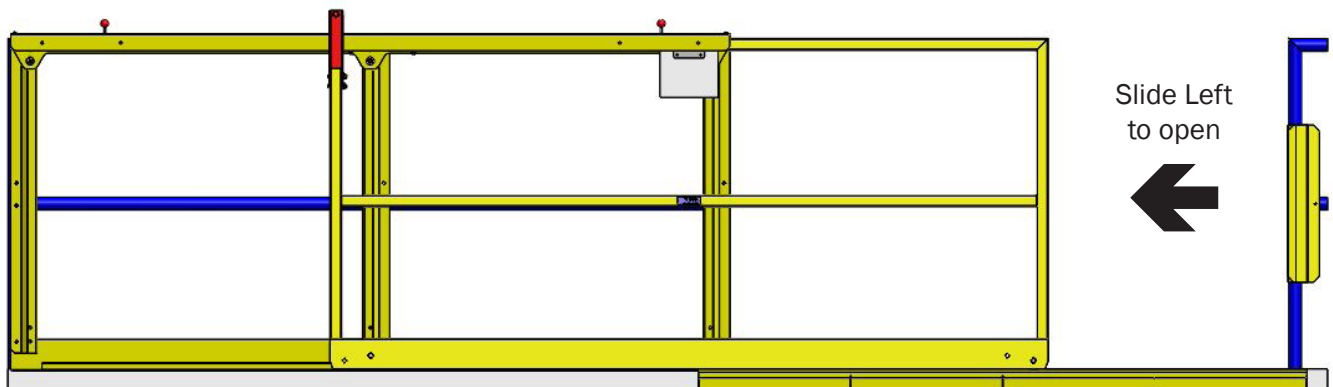

Illustration 2. Slide Left view from ground.

If you have chosen Slide Left, you will install your gate using the holes marked with a (-) sign.



Installing Horizontal Mezzanine Gate - Face Mount Only

Step 2.

A. Installation of the Face Mount Track for Face Mount only.

1. Field fasten Face Mount Track $\frac{1}{4}$ " below the top of the mezzanine deck.
2. Face Mount Track must be 4" beyond the edge of the opening in the direction of slide (See Page 4 to determine Slide Direction).

Illustration 3.

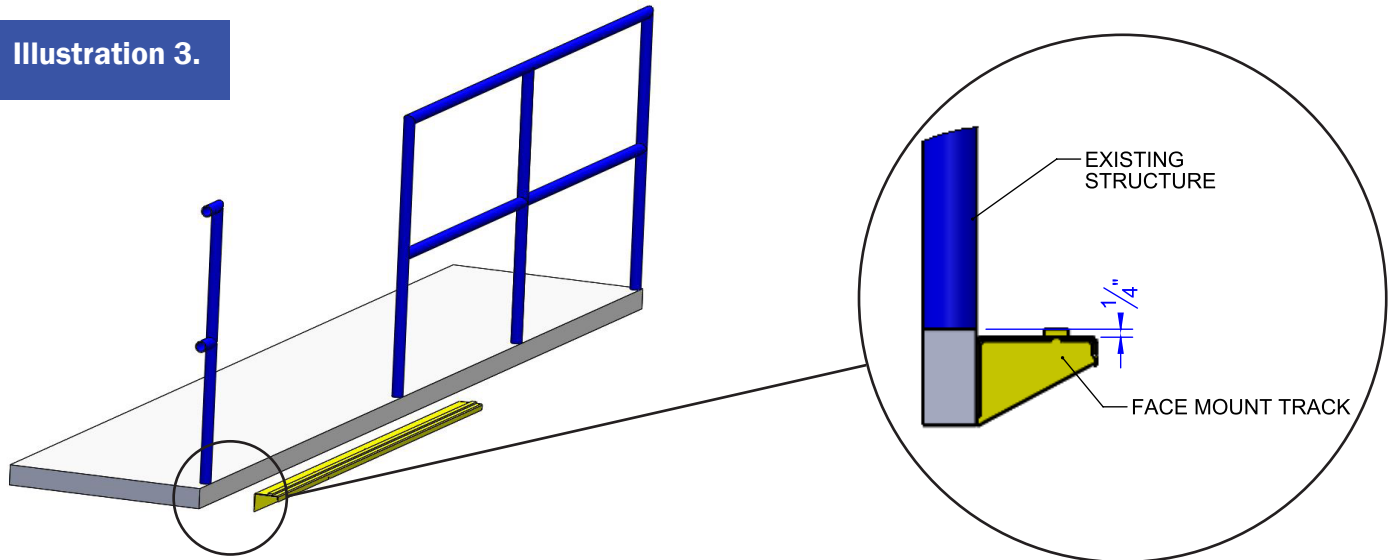

B. Installation of the Gate Housing Track for Face Mount only.

1. Place Gate Housing Track on top of the Face Mount Track and slide it up against the already mounted Face Mount Track.
2. Field fasten Gate Housing Track to the existing structure using factory located holes (Fasteners provided by others).
3. Once you have completed this step, go to step 4.

Illustration 4.

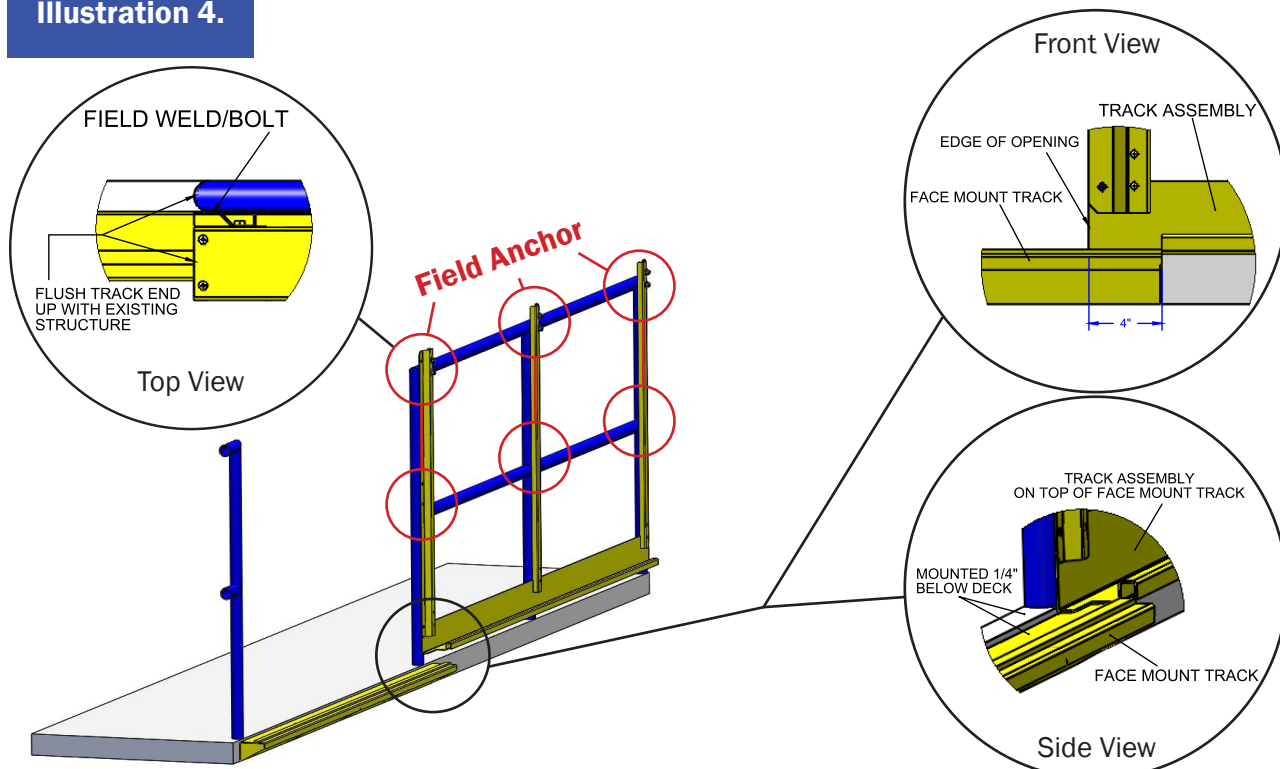

Installing Horizontal Mezzanine Gate - Deck Mount Only

Step 3.

A. Installation of the Gate Housing Track for Deck Mount only.

1. Field fasten Gate Housing Track to your existing structure using factory located holes (Fasteners provided by others).

NOTICE Face Mount Track Structure not needed - Dispose of Component.

Illustration 5.

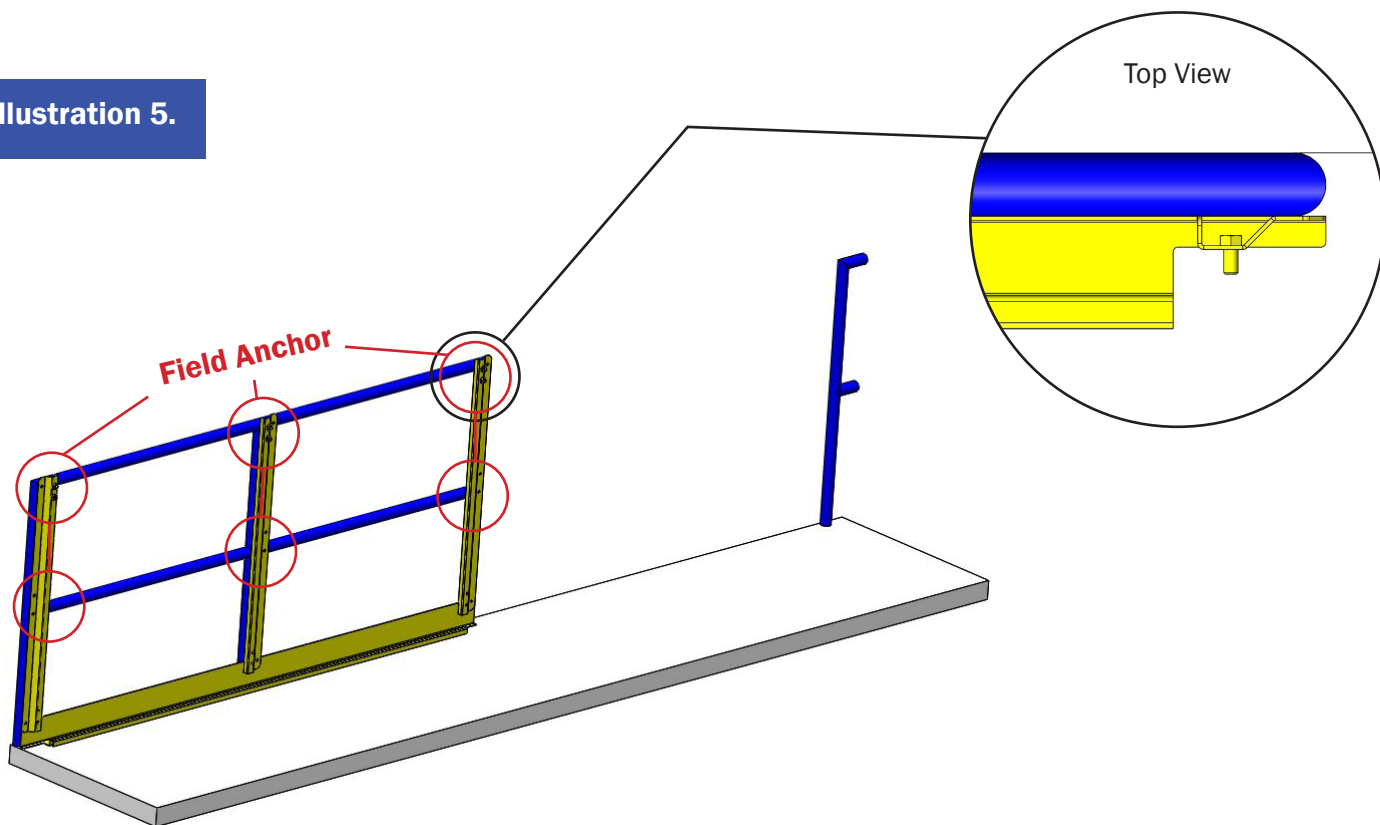

Installing Horizontal Mezzanine Gate - Assemble the Shroud

Step 4.

A. Take the Stop Bracket and hardware out of the Track Shroud Kit (See Illustration 6.). Install the Stop Bracket to the NON-SLIDE DIRECTION of the Shroud.

Illustration 6.

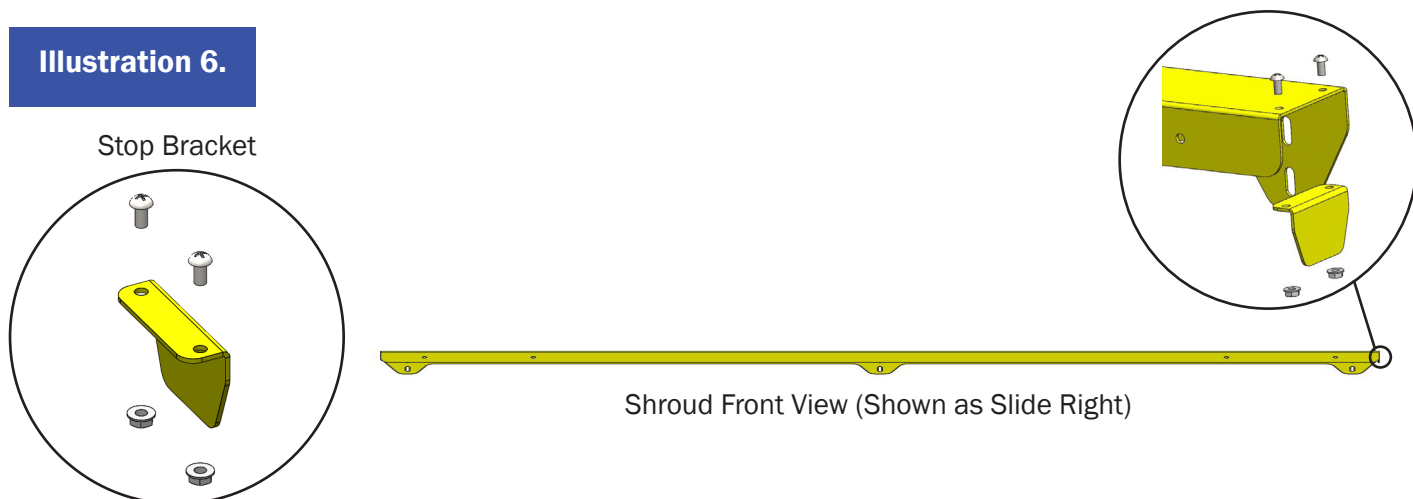

Installing Horizontal Mezzanine Gate - Manual Only

Step 5. Installation of the Manual Kit for Manual Gates only.

A. Install manual latches to the shroud.

B. Once you have completed this step, go to step 7.

Illustration 7.

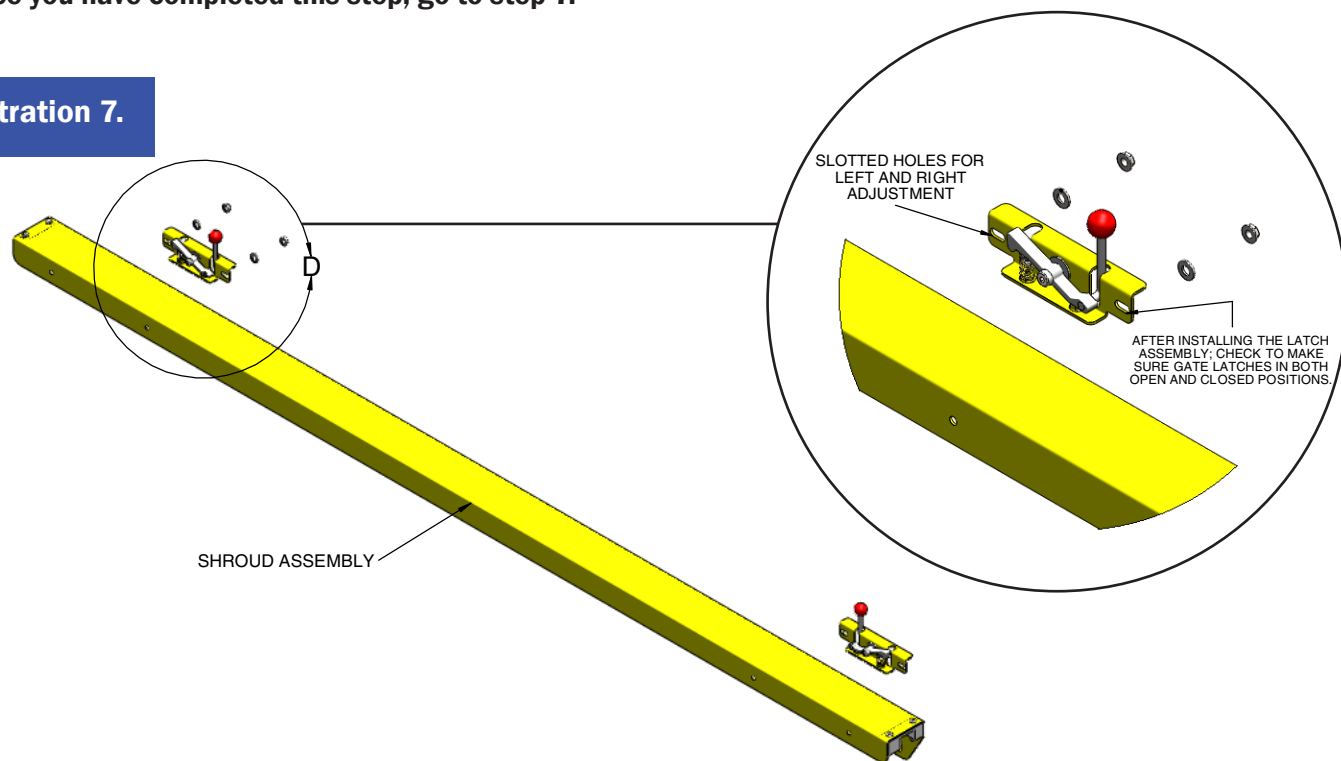
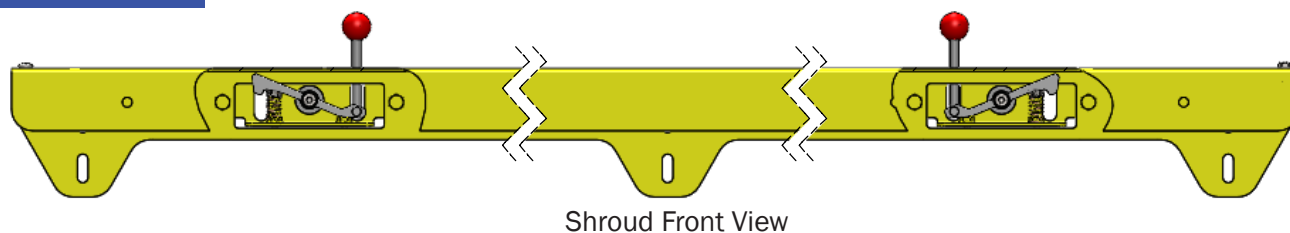

Illustration 8.



Installing Horizontal Mezzanine Gate - Electric Only

Step 6. Install the cover plates found in the Electric Operator Kit.

A. Dispose of Manual Latch Assemblies

B. Install Cover Plates over Manual Latch locations.

Illustration 7.

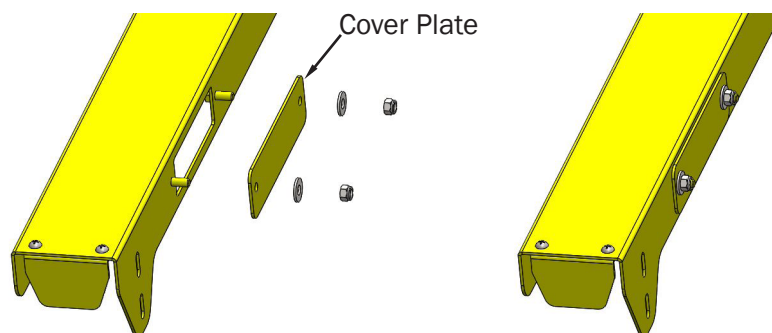

Installing Horizontal Mezzanine Gate - Gate Assembly

Step 7.

A. Install front wheel in leading end of gate. Must be in Lower hole.

Illustration 8.

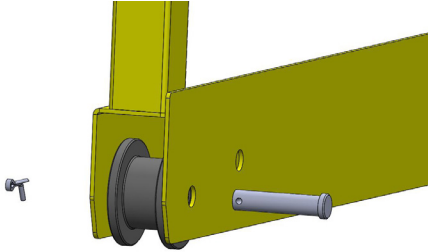

B. Install rear wheel in the trailing end of gate. Must be in the Upper hole.

Illustration 9.

Slide Right Shown

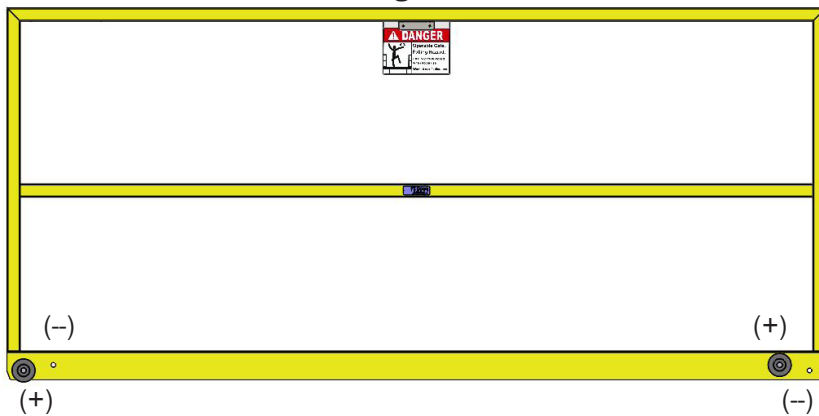
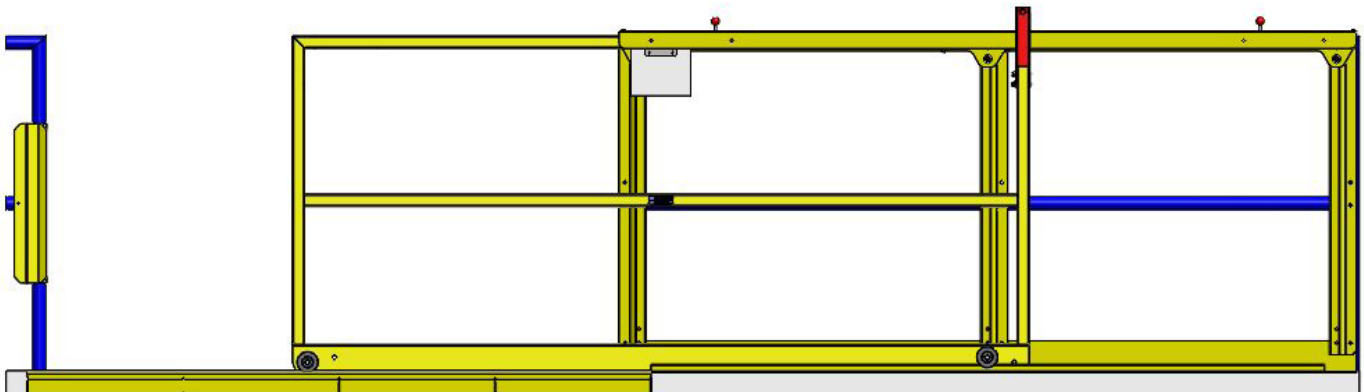

Illustration 10.

Slide Right Shown



Installing Horizontal Mezzanine Gate - Gate Assembly

Step 8.

A. Install rear flat UHMW guide block on top of gate structure. The notch must be towards center of gate.

Illustration 11.

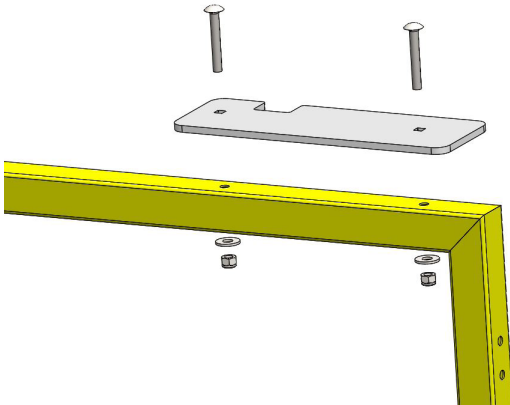
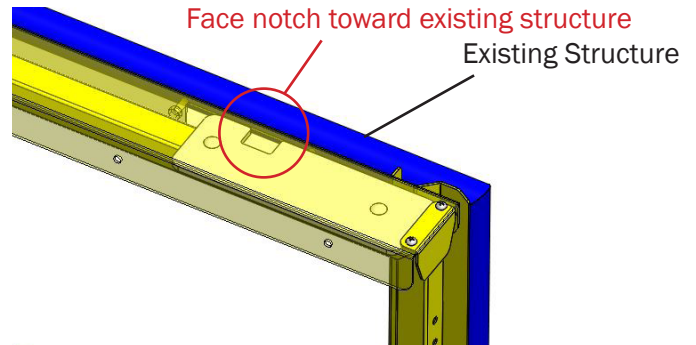

Illustration 12.



Installing Horizontal Mezzanine Gate - Manual Only

Step 9. Manual Gates only.

A. Install Red Pull Handle. Must be installed on the trailing end of the gate.

B. Once you have completed this step, go to step 11.

Illustration 13.

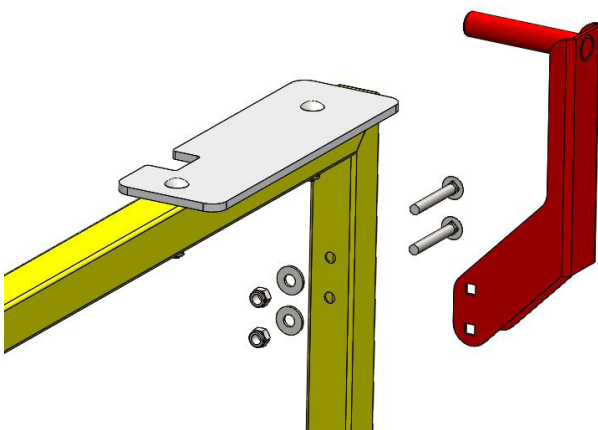
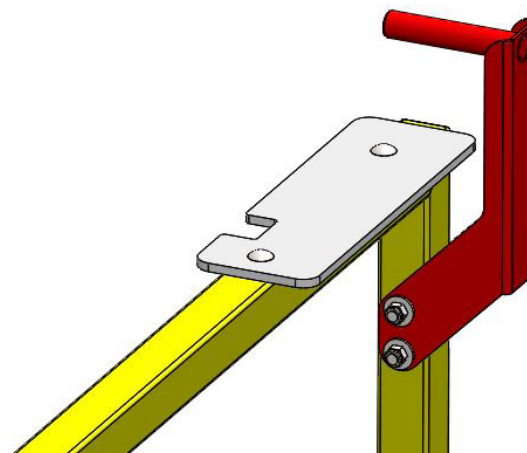

Illustration 14.



Installing Horizontal Mezzanine Gate - Electric Only

Step 10. Electric Gates only.

A. Install Drive Belt Anchor Buckle on trailing end of gate.

Illustration 15.

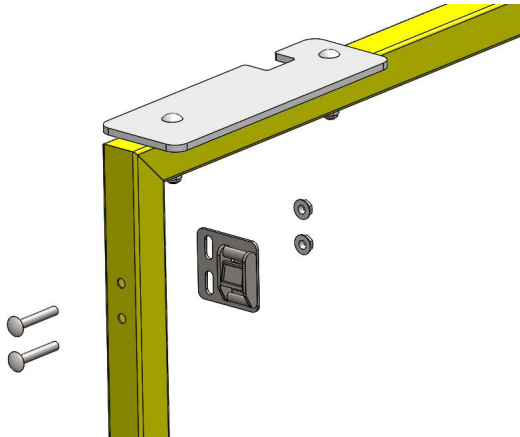
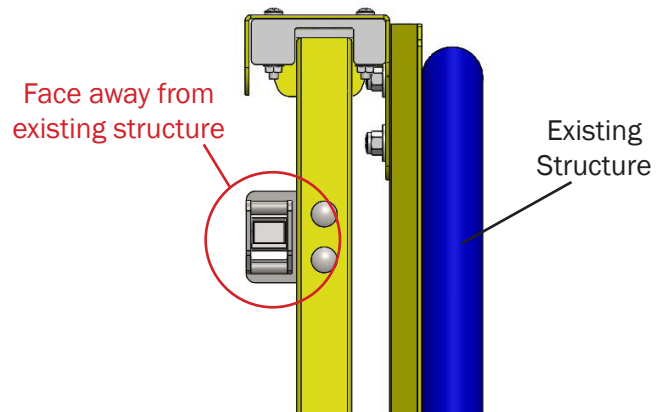

Illustration 16.



Installing Horizontal Mezzanine Gate

Step 11.

A. Attach Shroud to Gate Housing Track.

Illustration 17.

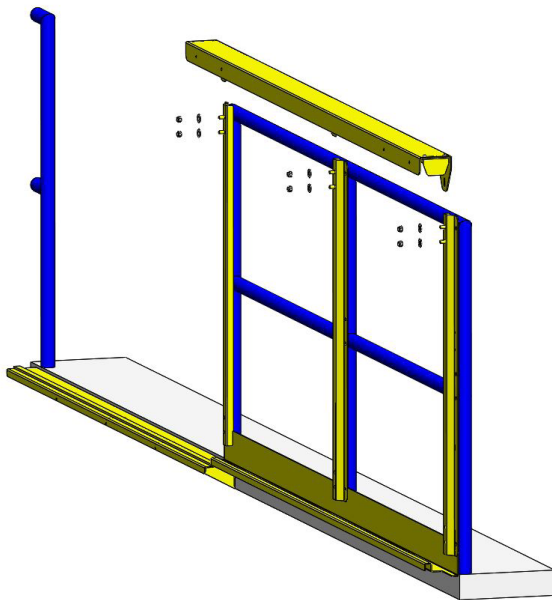
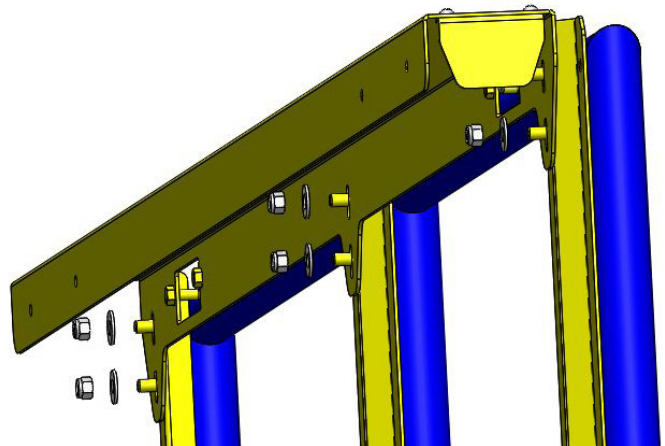

Illustration 18.



Installing Horizontal Mezzanine Gate - Electric Only

Step 12. Electric Gates only.

A. Mount Operator

1. Remove Pulley Cover from Operator housing and set aside for installation later.
2. Mount Operator to Gate Housing Track Shroud. Note: Operator should be mounted on the shroud, closest to the opening.

Illustration 15.

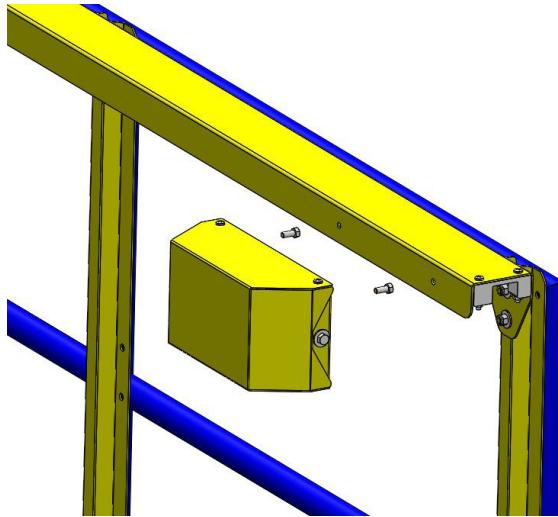

Installing Horizontal Mezzanine Gate

Step 13. Install Gate Assembly

- #### A. Slide Gate Assembly into Track Shroud and continue to slide gate to the fully open position.

Illustration 16.

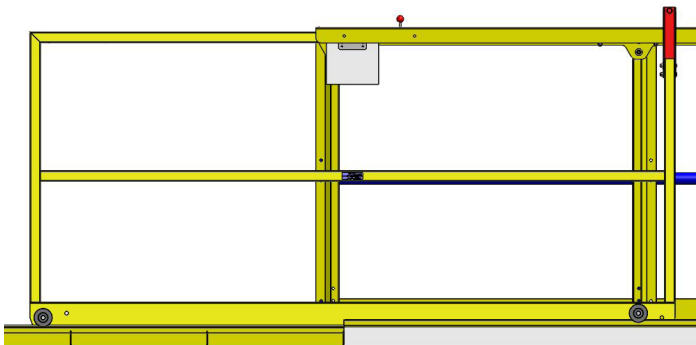
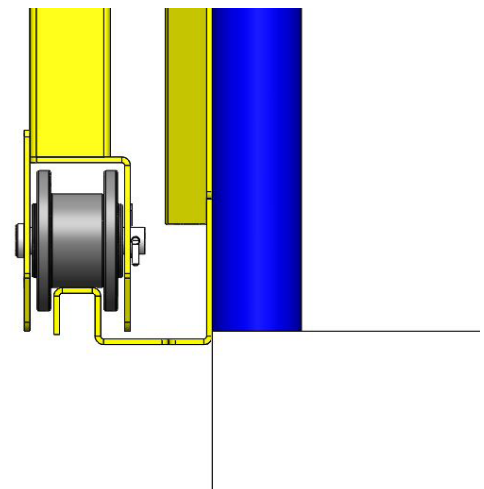

Illustration 17.



Installing Horizontal Mezzanine Gate

Illustration 18.

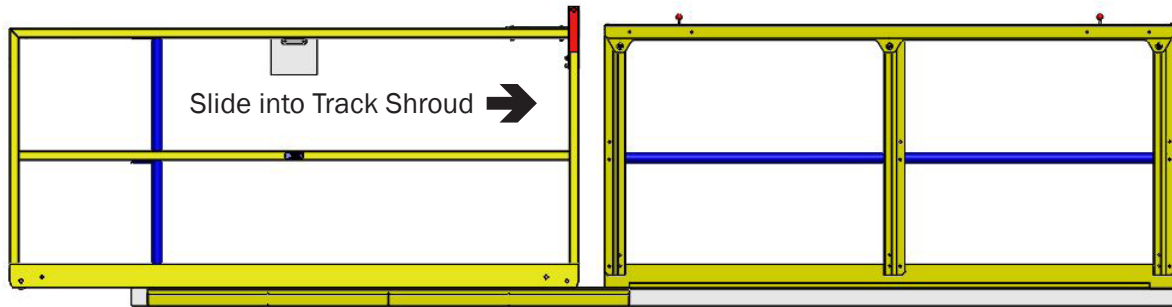
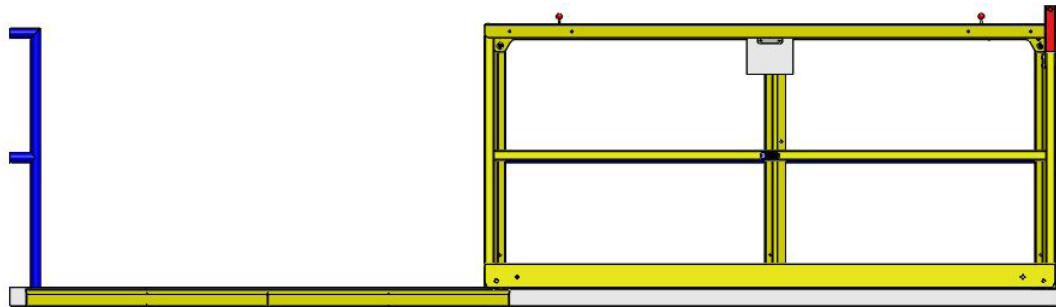

Illustration 19.



Step 14. Install Guide Block.

A. Install Guide Block using provide hardware.

Illustration 20.

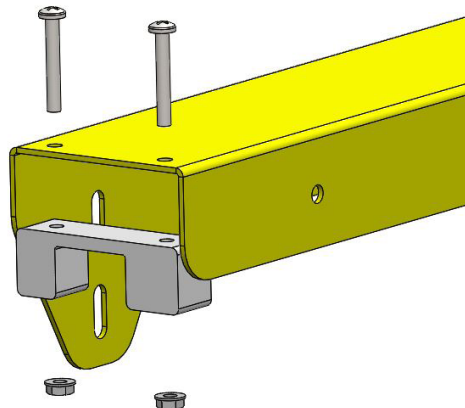
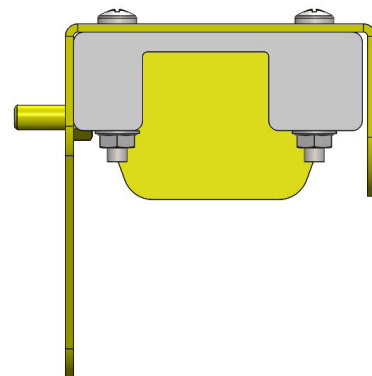

Illustration 21.



Installing Horizontal Mezzanine Gate

Step 15. Install Stop Jamb

- A. Field fasten Stop Jamb centered vertically.
- B. Attach the Stop Jamb on adjacent mezzanine opening structure. Shim as required.

Illustration 22.

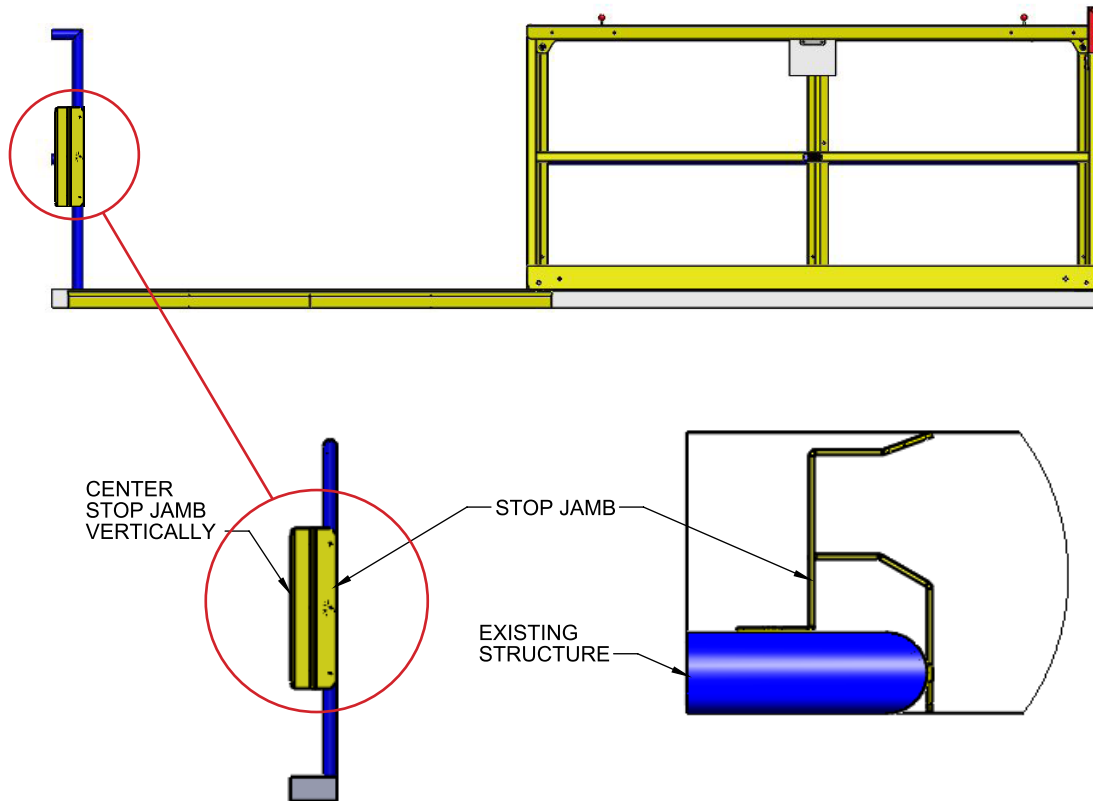

PS DOORS—Limited Warranty

Limited Warranty - Fill out warranty registration and return to PS DOORS.

PS DOORS warrants this product and components to be free from defects in material and workmanship for a period of one (1) year from date of shipment. If within the term of this warranty, any Horizontal Mezzanine Gate or component is found to be defective upon inspection by an authorized PS DOORS representative, PS DOORS will replace or repair, at PS DOORS' discretion, any part found to be defective. Any field labor charges incurred are the sole responsibility of the customer.

To make a claim under this warranty, contact PS DOORS at the address shown below.

PS DOORS	Toll Free: 877.446.1519
Attention: Warranty	Phone: 701.746.4519
1150 South 48th Street	Fax: 701.746.8340
Grand Forks, ND 58201	E-mail: 4psinfo@psdoors.com

Unauthorized modification of or to this product voids the PS DOORS Limited Warranty. Accordingly, if the product requires service after unauthorized modification, you can expect any request for warranty repair to be charged to you. Authorized modifications, received in writing from PS DOORS, as long as the modification is accomplished in strict accordance with PS DOORS' instructions, does not void warranty. To request product modifications contact PS DOORS at the address above.

PS DOORS SHALL NOT BE LIABLE FOR ANY CONSEQUENTIAL OR INCIDENTAL DAMAGES.

All other warranty's, express or implied including any warranty of merchantability, are expressly excluded. Some states do not allow the exclusion or limitation of consequential or incidental damages, so the above limitation or exclusion may not apply to you.

WARRANTY DOES NOT APPLY TO ANY DAMAGE OR DETERIORATION CAUSED BY MODIFICATION, ABUSE, APPLIED PAINT FAILURE OR FAILURE TO PROVIDE REASONABLE AND NECESSARY MAINTENANCE.

This warranty gives you specific legal rights, and you may also have other rights, which vary, from state to state, or by country.

Exclusions:

Lifting Straps are considered a "wear-item" and are not covered under this warranty.